

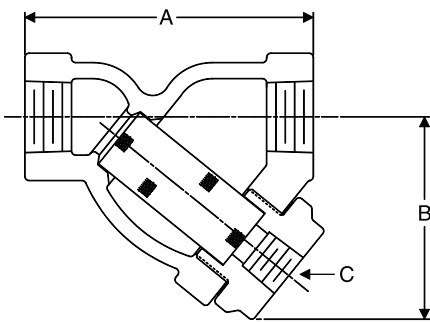

Cast Iron 250 lb Screwed 1/2" - 3"

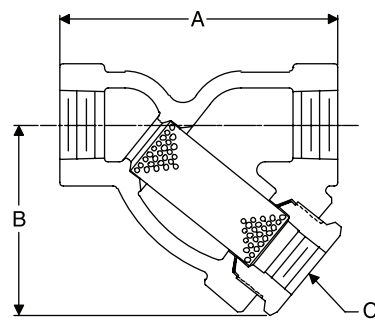

CA1SC/CA41SC 1/2", 3/4", 1", 1 1/2", 2"



CA1SC/CA41SC 1 1/4"

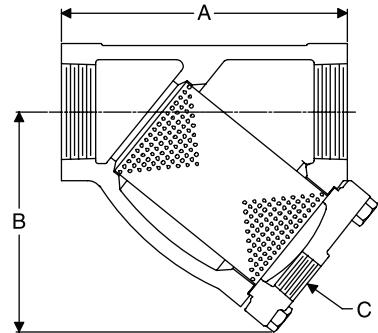

A1SC 2 1/2", 3"

Pressure/Temperature Rating

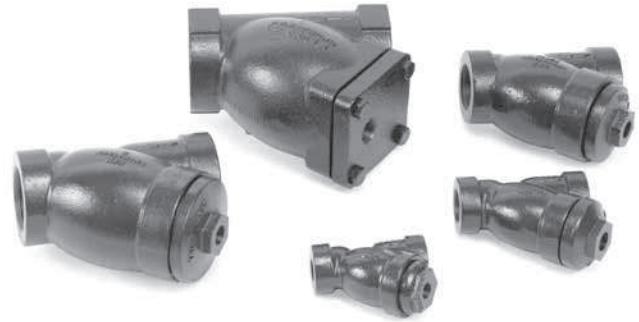
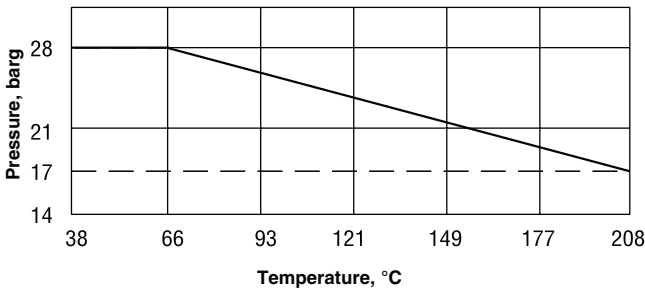

Strainers

Table S-322-1. Materials: 250 lb Screwed 1/2" - 3"

Connection Size in	Body	Standard Screen	Screen Retainer	Gasket	Bolting
1/2", 3/4"	ASTM A48 Class 30 Cast Iron	30x30 SS Mesh or 304 SS 0,045" perforated †	ASTM A48 Class 30 Cast Iron	Spiral wound	N/A
1", 1 1/2", 2"				Soft Steel	
1 1/4"				Non-asbestos	Cap Screws ASTM A193 Gr. B7
2 1/2", 3"					

† Note: Other screen materials available. See page S-321.

Table S-322-2. Physical Data: 250 lb Screwed 1/2" - 3"

Connection Size in	Ordering Code, Standard Screen	Weight kg	Dimensions			Maximum Pressure		Screen Retainer Type	Connections						
			A mm	B mm	C in	Saturated Steam bar	66°C non-shock bar								
1/2"	CA1SC CA41SC	1,4	108	76	3/8"	17	28	Threaded	ANSI B1.20.1 Screwed						
3/4"		2,0	127	95	1/2"										
1"										3,0	140	98			
1 1/4"													4,5	160	113
1 1/2"															
2"	A1SC	11,0	216	164	3/4"	Bolted									
2 1/2"		21,0	267	203	1 1/4"										
3"															

All sizes comply with the article 3.3 of the PED (97/23/EC).

All dimensions and weights are approximate. Use certified print for exact dimensions. Design and materials are subject to change without notice.

Cast Iron Class 125 Flanged 2" - 10" and Class 250 Flanged 2" - 8"

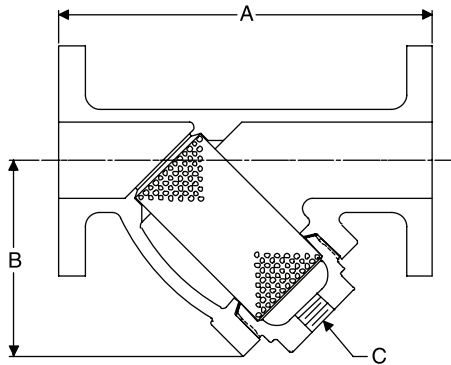

2" Class 125 or 250 Flanged

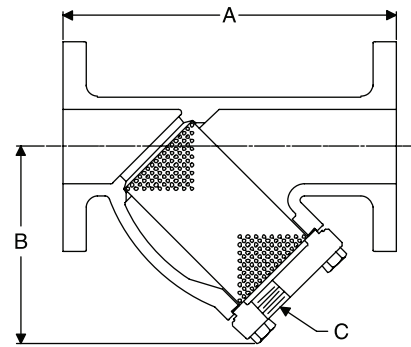

2 1/2" - 10" Class 125 Flanged, 2 1/2" - 8" Class 250 Flanged



Table S-323-1. Materials: Class 125 Flanged 2" - 10" and Class 250 Flanged 2" - 8"

Connection Size in	Body	Screen Retainer	Gasket	Bolting	Standard screen
2"	ASTM A48 Class 30 Cast Iron		Soft Steel	N/A	304 SS 0,045" perforated †
2 1/2", 3", 4", 6", 8"				Cap Screws ASTM A193	
10" Class 125 Only			Non-asbestos		304 SS 1/8" perforated †

† Note: Other screen materials available. See page S-321.

Table S-323-2. Physical Data: Class 125 Flanged 2" - 10" and Class 250 Flanged 2" - 8"

Connection Size in	Ordering Code, Standard Screen	Weight kg	Dimensions			Maximum Pressure		Screen Retainer Type	Connection
			A mm	B mm	C in	Saturated Steam bar	66°C non-shock bar		
2"	A1FL 125	10	248	130	1/2"	8,6	12	Threaded	Class 125 ANSI B16.1 Flat Faced
2 1/2"		16	281	164	3/4"			Bolted	
3"		22	311	184	1 1/4"			Bolted	
4"		38	378	241	1 1/4"				
6"	A1FL 125	85	519	353	1 1/2"	8,6	12	Bolted	
8"	A8FL 125	145	603	451	2"				
10"	A8FL 125	257	746	546	2"				
2"	A1FL 250	11	260	130	1/2"	17	28	Threaded	Class 250 ANSI B16.1 1/16" RF
2 1/2"	A1FL 250	19	297	164	3/4"	17	28	Bolted	
3"		32	359	216	1 1/4"				
4"		57	435	273	1 1/4"				
6"		133	597	400	1 1/2"				
8"		230	699	514	2"				

Shade indicates products that are CE Marked according to the PED (97/23/EC). All the other sizes comply with the Article 3.3 of the same directive.

All dimensions and weights are approximate. Use certified print for exact dimensions. Design and materials are subject to change without notice.